

PALM BEACH COUNTY BIOTECHNOLOGY RESEARCH PARK

PORTION OF THE WEST ONE-HALF (W 1/2) OF SECTION 5, PORTION OF SECTION 6 ALL OF SECTION 7 AND THE WEST ONE-HALF (W 1/2) SECTION 8 TOWNSHIP 42 SOUTH, RANGE 41 EAST, PALM BEACH COUNTY, FLORIDA.

JULY 2004

SHEET 1 OF 3

STATE OF FLORIDA
COUNTY OF PALM BEACH
This plat was filed for record at 11:38 AM this 30 day of November, 2004, and duly recorded in Plat Book 103, Pages 108, Through 110.

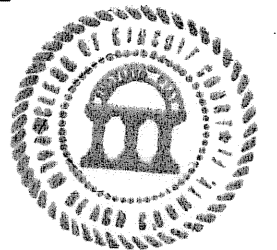

DOROTHY H. WILKEN
Clerk of Circuit Court
By: *Christina J. M...*

DEDICATION AND RESERVATION

KNOW ALL MEN BY THESE PRESENTS THAT LANTANA FARM ASSOCIATES, INC., A FLORIDA CORPORATION, ALSO KNOWN AS (AKA) LANTANA FARMS ASSOCIATES, INC., OWNER OF THE LAND SHOWN HEREON AS PALM BEACH COUNTY BIOTECHNOLOGY RESEARCH PARK, BEING MORE PARTICULARLY DESCRIBED AS FOLLOWS:

THE WEST ONE-HALF (W 1/2) OF SECTION 5; ALL OF SECTIONS 6 AND 7; AND THE WEST ONE-HALF (W 1/2) OF SECTION 8, TOWNSHIP 42 SOUTH, RANGE 41 EAST, PALM BEACH COUNTY, FLORIDA, LESS THE RIGHT OF WAY OF SOUTH FLORIDA WATER MANAGEMENT DISTRICT CANAL C-18, AS RECORDED IN DEED BOOK 1097, PAGE 261 OF THE PUBLIC RECORDS OF PALM BEACH COUNTY, FLORIDA.

CONTAINING: 1,919.23 ACRES, MORE OR LESS.

HAVE CAUSED THE SAME TO BE SURVEYED AND PLATTED AS SHOWN HEREON AND DO HEREBY DEDICATE AS FOLLOWS:

TRACT "A", AS SHOWN HEREON, IS HEREBY RESERVED FOR THE FEE SIMPLE OWNER, ITS SUCCESSORS AND ASSIGNS, FOR USE IN ACCORDANCE WITH THE ZONING APPROVAL OF RECORD FOR THIS SITE, INCLUDING FUTURE AMENDMENTS, ON FILE WITH THE PALM BEACH COUNTY ZONING DIVISION. THE MAINTENANCE OF THIS SITE SHALL BE THE PERPETUAL OBLIGATION OF THE FEE SIMPLE OWNER, ITS SUCCESSORS AND ASSIGNS, AND WITHOUT RECOURSE TO PALM BEACH COUNTY IN THE EVENT PALM BEACH COUNTY IS NOT THE FEE SIMPLE OWNER.

IN WITNESS WHEREOF, THE ABOVE-NAMED CORPORATION HAS CAUSED THESE PRESENTS TO BE SIGNED BY ITS President AND ITS CORPORATE SEAL TO BE AFFIXED HERETO BY AND WITH THE AUTHORITY OF ITS BOARD OF DIRECTORS THIS 9th DAY OF November, 2004.

LANTANA FARM ASSOCIATES, INC. AKA: LANTANA FARMS ASSOCIATES, INC.
A FLORIDA CORPORATION,

WITNESS: Manuel... BY: Peter L. Mecca
CARL SMISIEL LEONARDO MECCA Peter L. Mecca
PRINTED NAME PRINTED NAME

WITNESS: Carmella Cordano STEPHENIE WINSTON President
Carmella Cordano TITLE
PRINTED NAME

ACKNOWLEDGEMENT

STATE OF FLORIDA
COUNTY OF PALM BEACH

BEFORE ME PERSONALLY APPEARED Peter L. Mecca WHO IS PERSONALLY KNOWN TO ME OR HAS PRODUCED AS IDENTIFICATION, AND WHO EXECUTED THE FOREGOING INSTRUMENT AS PRESIDENT OF LANTANA FARM ASSOCIATES, INC., A FLORIDA CORPORATION AKA LANTANA FARMS ASSOCIATES, INC. AND SEVERALLY ACKNOWLEDGED TO AND BEFORE ME THAT HE EXECUTED SUCH INSTRUMENT AS SUCH OFFICER OF SAID CORPORATION, AND THAT THE SEAL AFFIXED TO THE FOREGOING INSTRUMENT IS THE CORPORATE SEAL OF SAID CORPORATION AND THAT IT WAS AFFIXED TO SAID INSTRUMENT BY DUE AND REGULAR CORPORATE AUTHORITY, AND THAT SAID INSTRUMENT IS THE FREE ACT AND DEED OF SAID CORPORATION.

WITNESS MY HAND AND OFFICIAL SEAL THIS 9th DAY OF November 2004.

MY COMMISSION EXPIRES: 1-15-05
STEPHENIE WINSTON
NOTARY PUBLIC

CC 981981
COMMISSION NUMBER STEPHENIE WINSTON
PRINT NAME



TITLE CERTIFICATION

STATE OF FLORIDA
COUNTY OF PALM BEACH

I, HENRY B. HANDLER, A DULY LICENSED ATTORNEY IN THE STATE OF FLORIDA, DO HEREBY CERTIFY THAT I HAVE EXAMINED THE TITLE TO THE HEREON DESCRIBED PROPERTY; THAT I FIND THE TITLE TO THE PROPERTY IS VESTED IN LANTANA FARM ASSOCIATES, INC., AKA LANTANA FARMS ASSOCIATES, INC. THAT THE CURRENT TAXES HAVE BEEN PAID; THAT THERE ARE NO MORTGAGES OF RECORD; AND THAT THERE ARE ENCUMBRANCES OF RECORD BUT THOSE ENCUMBRANCES DO NOT PROHIBIT THE CREATION OF THE SUBDIVISION DEPICTED BY THIS PLAT.

DATE: Oct. 29, 2004
Henry B. Handler
HENRY B. HANDLER, ATTORNEY
LICENSED IN FLORIDA

COUNTY APPROVAL

COUNTY ENGINEER:

THIS PLAT IS HEREBY APPROVED FOR RECORD PURSUANT TO PALM BEACH COUNTY ORDINANCE 95-33, AND IN ACCORDANCE WITH SEC. 177.071 (2), F.S., THIS 30 DAY OF November, 2004, AND HAS BEEN REVIEWED BY A PROFESSIONAL SURVEYOR & MAPPER EMPLOYED BY PALM BEACH COUNTY IN ACCORDANCE WITH SEC. 177.081 (1) F.S.

George T. Webb
GEORGE T. WEBB, P.E.
COUNTY ENGINEER

SURVEYOR AND MAPPER'S CERTIFICATE

THIS IS TO CERTIFY THAT THE PLAT SHOWN HEREON IS A TRUE AND CORRECT REPRESENTATION OF A SURVEY MADE UNDER THE RESPONSIBLE DIRECTION AND SUPERVISION OF A PROFESSIONAL SURVEYOR AND MAPPER; THAT SAID PLAT IS ACCURATE TO THE BEST OF MY KNOWLEDGE AND BELIEF; THAT PERMANENT REFERENCE MONUMENTS ("P.R.M.s"), HAVE BEEN PLACED AS REQUIRED BY LAW; AND, FURTHER, THAT THE PLAT COMPLIES WITH ALL THE SURVEY REQUIREMENTS OF CHAPTER 177, FLORIDA STATUTES, AS AMENDED, AND THE ORDINANCES OF PALM BEACH COUNTY, FLORIDA.

Mark E. Hummel 11/02/04
MARK E. HUMMEL, P.S.M.
LICENSE NO. 5201
STATE OF FLORIDA
MILLER LEGG & ASSOCIATES, INC.
2005 VISTA PARKWAY, SUITE 100
WEST PALM BEACH, FLORIDA 33411-2719
CERTIFICATE OF AUTHORIZATION No. LB 6680

SURVEYOR'S NOTES:

- ALL BEARINGS SHOWN HEREON ARE RELATIVE TO THE NORTH LINE OF SECTION 6, TOWNSHIP 42 SOUTH, RANGE 41 EAST, SAID NORTH LINE HAVING A BEARING OF NORTH 89°56'58" EAST.
- DENOTES PERMANENT REFERENCE MONUMENT (LB 6680 UNLESS OTHERWISE NOTED).
- PLAT POSITION AND ORIENTATION:
 - COORDINATES SHOWN ARE GRID
 - DATUM = NORTH AMERICAN DATUM (NAD) OF 1983, 1990 ADJUSTMENT
 - ZONE = FLORIDA EAST ZONE
 - LINEAR UNIT = U.S. SURVEY FEET
 - COORDINATE SYSTEM = 1983 STATE PLANE TRANSVERSE MERCATOR PROJECTION
 - ALL DISTANCES SHOWN ARE GROUND DISTANCES.
 - SCALE FACTOR IS 1.000004
 - GROUND DISTANCE X SCALE FACTOR = GRID DISTANCE

NOTICE: THIS PLAT, AS RECORDED IN ITS GRAPHIC FORM, IS THE OFFICIAL DEPICTION OF THE SUBDIVIDED LANDS DESCRIBED HEREIN AND WILL IN NO CIRCUMSTANCES BE SUPPLANTED IN AUTHORITY BY ANY OTHER GRAPHIC OR DIGITAL FORM OF THE PLAT. THERE MAY BE ADDITIONAL RESTRICTIONS THAT ARE NOT RECORDED ON THIS PLAT THAT MAY BE FOUND IN THE PUBLIC RECORDS OF THIS COUNTY.

THIS INSTRUMENT WAS PREPARED BY MARK E. HUMMEL, PSM, OF MILLER LEGG & ASSOCIATES, 2005 VISTA PARKWAY, SUITE 100, WEST PALM BEACH FLORIDA

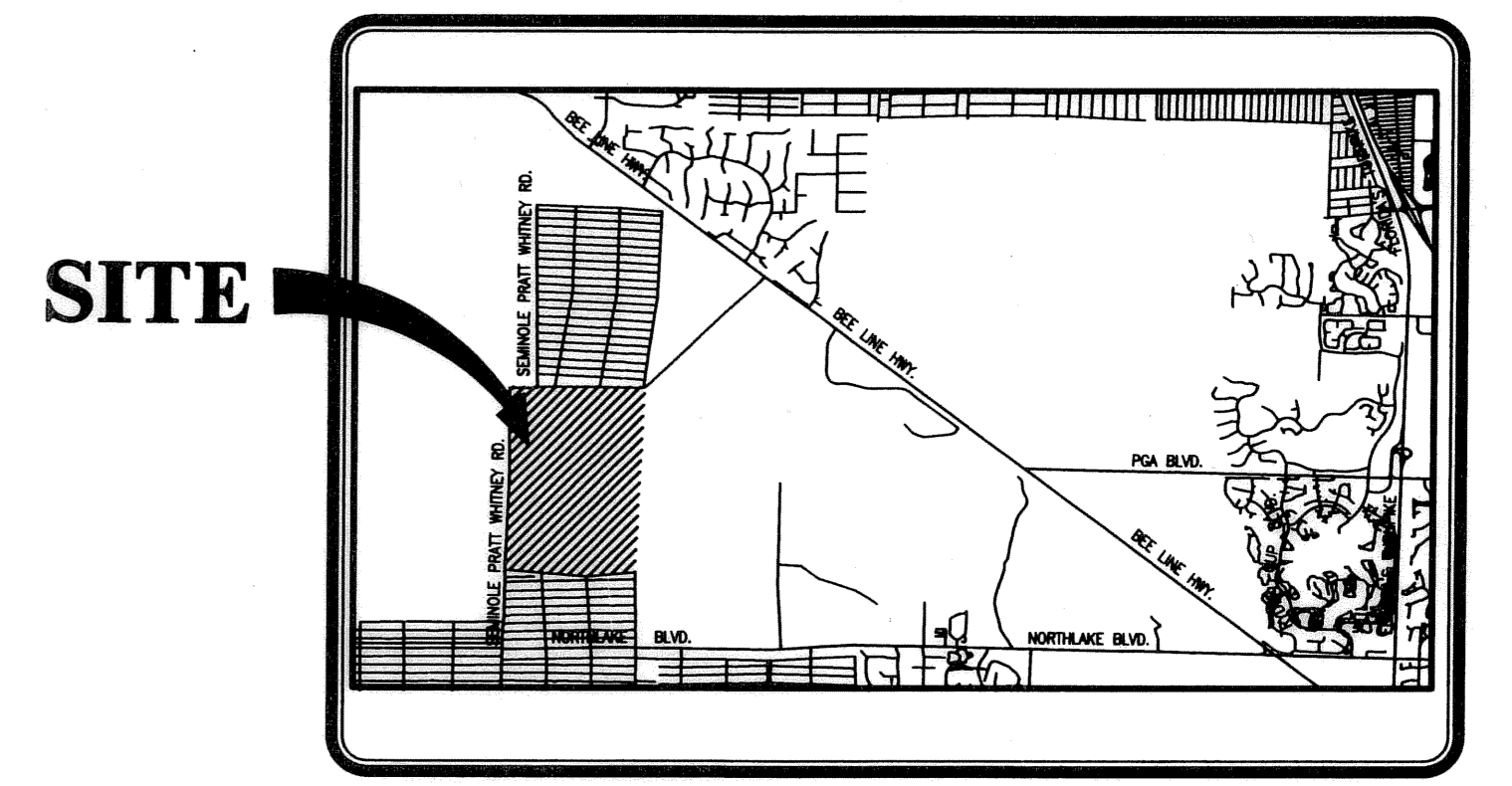

LOCATION MAP
N.T.S.

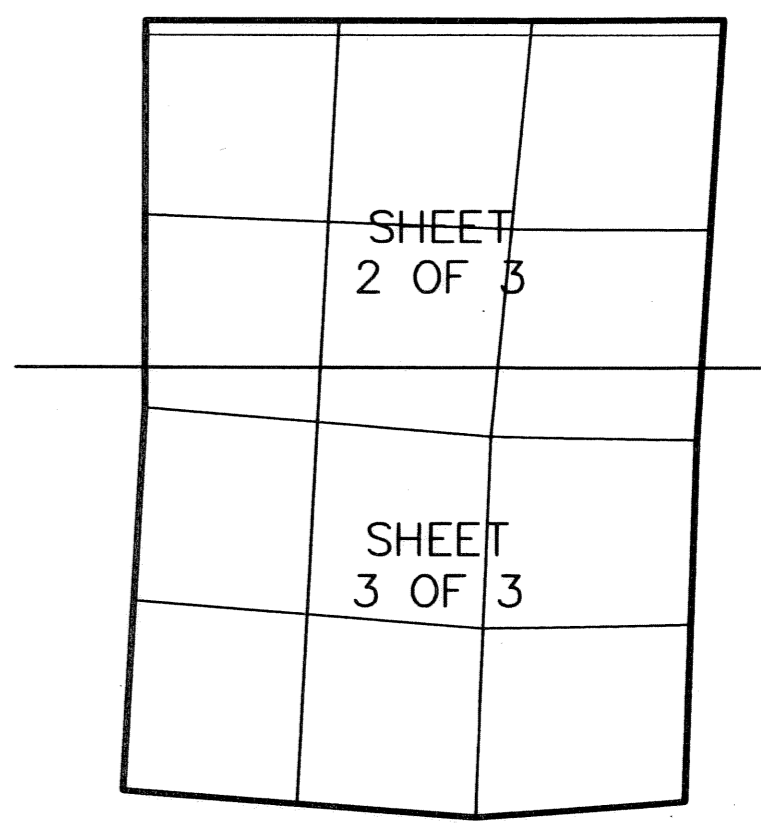

MAP SHEET INDEX
N.T.S.

SUBDIVISION Palm Beach County Biotechnology Research Park
BOOK 103 PAGE 108 FLOOD MAP # 50 B
FLOOD ZONE B ZONING AR ZIP CODE 33412
QUAD # 79
SE TAZ 824
PUD NAME

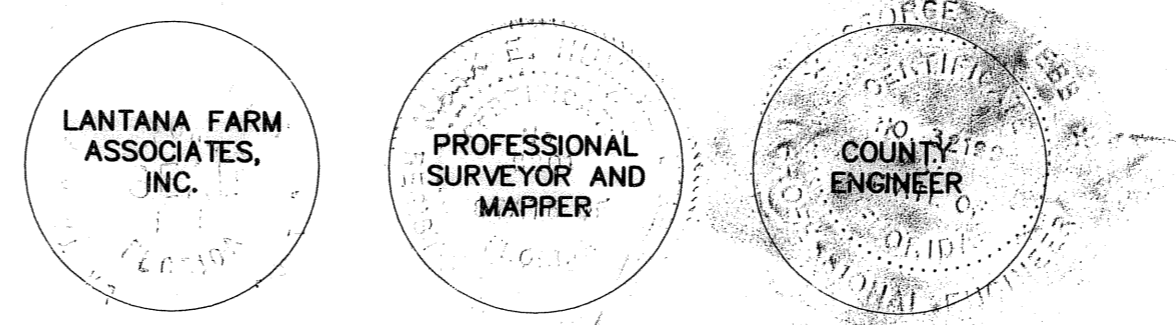

Engineers Planners
Land Surveyors
Environmental
Professionals License
Business No. 6680
MILLER LEGG
& ASSOCIATES, INC.
2005 Vista Parkway
Suite 100
West Palm Beach
Florida 33411-2719
(561) 689-1138
Fax: (561) 689-8108